

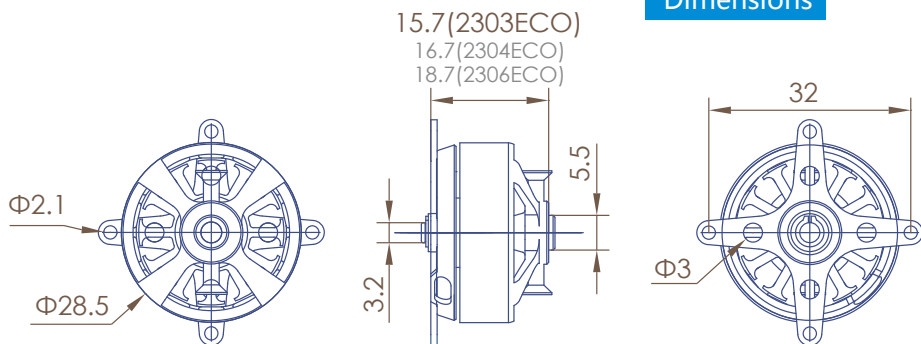

ECO 2303C-V2

Dimensions



Specification

ECO-C Series	ECO 2303C		
SKU(商品编码)	51635	51636	51637
KV(KV值)	2000	1800	1470
Turns(匝数)	23	25	31
Weight(g)(重量)	19	19	19
Dimensions(D x L)[mm](尺寸)	28.5x15.7	28.5x15.7	28.5x15.7
Slots & Poles(槽数, 极数)	12N14P	12N14P	12N14P
Ri(mOhm)(电阻)	170.2	276.0	377.0
Io @10V (A)(空载电流)	0.4	0.4	0.3
No.of Cells(LiPo)(适用电池)	2..3	2..3	2..3
Max. EfficiencyCurrent[A](效率电流)	7	6	5
Max. Burst Current (15S)[A](最大电流)	11.5	10	8
Max. Power(15S)[W](最大功率)	92	80	96
Max. Torque [N*M](最大扭矩)	0.066	0.064	0.062
Shaft diameter(mm)(轴径)	3.175	3.175	3.175
Mountingholes pitch(安装孔距)	32	32	32
Input Connectors(输入链接)	GC2.0	GC2.0	GC2.0
RecommendedESC(调速器)	XC-12-LITE or XC1010BA	XC-12-LITE or XC1010BA	XC-12-LITE or XC1010BA
Propeller(螺旋桨)	2S: 7x4E, PT 8x3i 3S: 5x3E	2S: PT 9x3E, 8x4.7SF 3S: 5x3E, 5.1x4.5E	2S: 9x4.7SF, 10x5E 3S: 7x4E, PT8x2.3i
Class(适用机种)	100-150g airplanes.e.g. F3P or indoor Freestyle		

ECO 2303C (2000KV)

7.4V Motor @ Optimum Efficiency 最佳效率点

Current
3.24
A

Voltage
7.26
V

Revolutions*
12858
rpm

electric Power
23.5
W

mech. Power
19.5
W

Efficiency
83.2
%

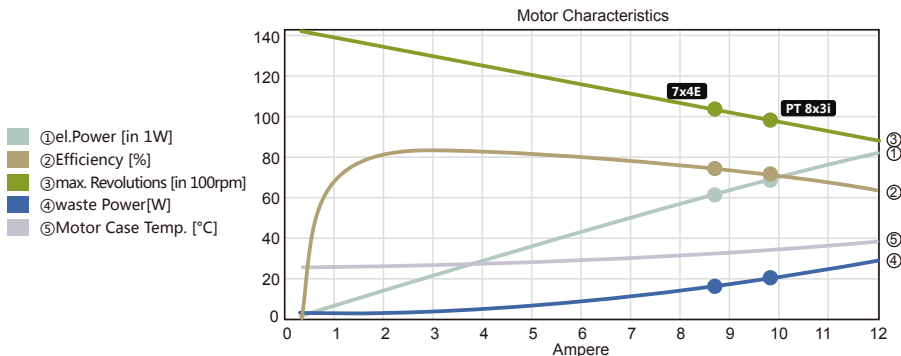

Voltage (V)	Propeller (RPM)	Throttle (%)	Current (A)	Voltage (V)	el. Power (W)	Efficiency (%)	Thrust (g)	Spec. Thrust (g/W)
7.4V (2S LIPO)	7x4E							
	5600	47	1.3	7.4	9.4	77.7	116	12.3
	6300	54	1.8	7.3	13.4	77.6	147	10.9
	7000	61	2.6	7.3	18.5	77.3	181	9.8
	7700	69	3.4	7.3	24.8	76.7	219	8.8
	8400	77	4.5	7.3	32.5	75.9	260	8
	9100	85	5.9	7.2	41.7	75.1	306	7.3
	9800	94	7.5	7.2	52.7	74.2	355	6.7
	10277	100	8.8	7.1	61.8	73.2	390	6.3
	PT 8x3i							
	4900	42	1.1	7.4	8.2	76.2	99	12.1
	5600	49	1.7	7.3	12.3	76	130	10.5
	6300	57	2.4	7.3	17.6	75.4	164	9.3
	7000	64	3.4	7.3	24.5	74.5	203	8.3
	7700	73	4.6	7.3	33	73.6	245	7.4
	8400	82	6.1	7.2	43.5	72.5	292	6.7
	9100	91	8	7.2	56.2	71.4	342	6.1
	9714	100	10	7.1	69.9	70	390	5.6

11.1V Motor @ Optimum Efficiency 最佳效率点

Current
4.69
A

Voltage
10.83
V

Revolutions*
19220
rpm

electric Power
50.8
W

mech. Power
42.5
W

Efficiency
83.7
%

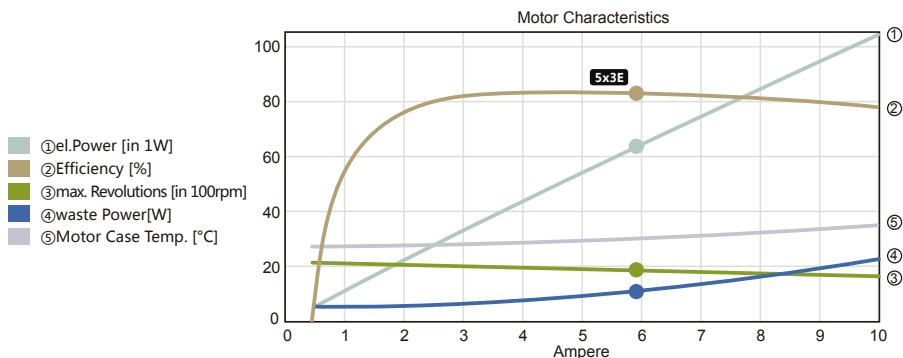

Voltage (V)	Propeller (RPM)	Throttle (%)	Current (A)	Volage (V)	el. Power (W)	Efficiency (%)	Thrust (g)	Spec. Thrust (g/W)
11.1V (3S LIPO)	5x3E							
	5600	27	0.2	11.1	2.2	66.1	32	14.7
	7000	34	0.3	11.1	3.8	73.4	49	13
	8400	42	0.6	11.1	6.2	77.8	71	11.5
	9800	49	0.9	11.1	9.5	80.5	97	10.2
	11200	56	1.3	11	13.9	82.2	127	9.1
	12600	64	1.8	11	19.5	83.2	160	8.2
	14000	72	2.4	11	26.6	83.8	198	7.4
	15400	80	3.2	11	35.2	84.1	239	6.8
	16800	88	4.2	10.9	45.7	84.2	285	6.2
	18200	97	5.4	10.9	58.2	84.1	334	5.7
	18640	100	5.9	10.8	63.2	83.4	351	5.6

ECO 2303C (1800KV)

7.4V Motor @ Optimum Efficiency 最佳效率点

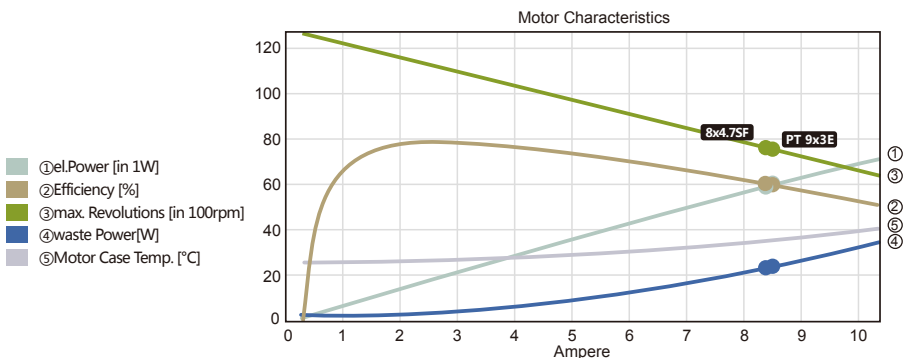

Voltage (V)	Propeller (RPM)	Throttle (%)	Current (A)	Volage (V)	el. Power (W)	Efficiency (%)	Thrust (g)	Spec. Thrust (g/W)
7.4V (2S LIPO)	8x4.75F							
	4500	50	1.6	7.4	11.6	66.7	119	10.2
	5000	57	2.2	7.3	16.2	65.8	147	9.1
	5500	64	3	7.3	21.9	64.6	178	8.1
	6000	72	4	7.3	29	63.4	212	7.3
	6500	81	5.3	7.2	37.6	62.2	249	6.6
	7000	90	6.8	7.2	48	60.9	288	6
	7489	100	8.6	7.1	60.7	59.3	330	5.4
	PT 9x3E							
	4000	42	1.1	7.4	7.9	67.6	104	13.1
	4500	49	1.6	7.4	11.3	67	131	11.6
	5000	56	2.2	7.3	15.8	66.1	162	10.3
	5500	64	3	7.3	21.3	65	196	9.2
	6000	72	3.9	7.3	28.2	63.8	233	8.3
	6500	80	5.1	7.2	36.6	62.6	274	7.5
	7000	89	6.6	7.2	46.6	61.3	317	6.8
	7500	99	8.3	7.1	58.5	60.1	364	6.2
	7537	100	8.6	7.1	60.2	59.6	368	6.1

11.1V Motor @ Optimum Efficiency 最佳效率点

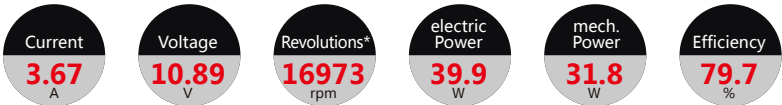

- ① el. Power [in 1W]
- ② Efficiency [%]
- ③ max. Revolutions [in 100rpm]
- ④ waste Power[W]
- ⑤ Motor Case Temp. [°C]

Motor Characteristics

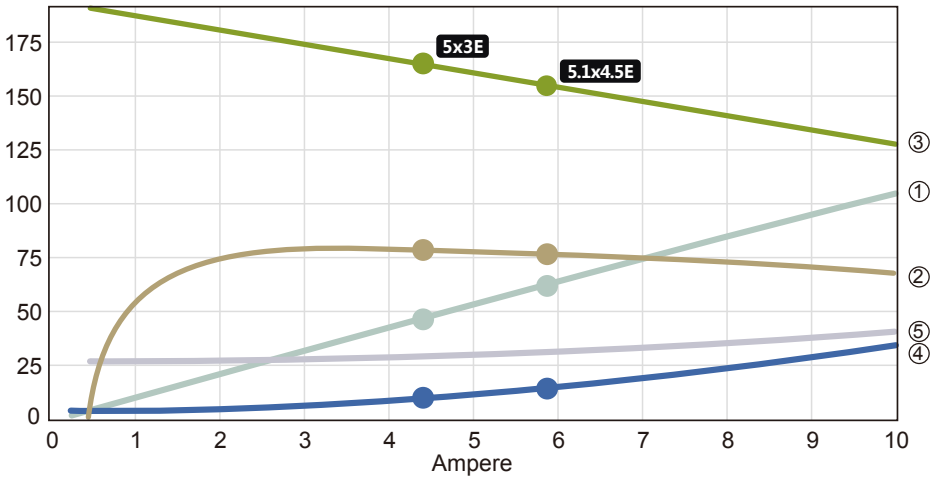

Voltage (V)	Propeller (RPM)	Throttle (%)	Current (A)	Volage (V)	el. Power (W)	Efficiency (%)	Thrust (g)	Spec. Thrust (g/W)
11.1V (3S LIPO)	5x3E							
	4800	26	0.1	11.1	1.6	55.8	23	14.5
	6000	33	0.2	11.1	2.7	64.5	36	13.4
	7200	40	0.4	11.1	4.3	70.3	52	12.1
	8400	47	0.6	11.1	6.5	74.1	71	11
	9600	54	0.8	11.1	9.4	76.7	93	9.9
	10800	62	1.2	11	13.1	78.3	118	9
	12000	69	1.6	11	17.7	79.4	145	8.2
	13200	77	2.1	11	23.3	80	176	7.5
	14400	85	2.8	11	30.2	80.4	209	6.9
	15600	93	3.5	10.9	38.3	80.5	246	6.4
	16569	100	4.3	10.9	46.5	79.6	277	6
	5.1x4.5E							
	3300	18	0.1	11.1	1	49.6	17	18.3
	4400	25	0.2	11.1	1.8	61.6	31	17.1
	5500	31	0.3	11.1	3.2	69.1	49	15.3
	6600	38	0.5	11.1	5.1	73.6	70	13.6
	7700	45	0.7	11.1	7.9	76.3	95	12.1
	8800	52	1	11.1	11.5	77.9	124	10.8
	9900	59	1.5	11	16.2	78.8	157	9.7
	11000	66	2	11	22.1	79.2	194	8.8
	12100	74	2.7	11	29.5	79.3	235	8
	13200	82	3.5	10.9	38.3	79.1	280	7.3
	14300	90	4.5	10.9	48.9	78.9	328	6.7
	15400	99	5.7	10.8	61.4	78.5	381	6.2
	15496	100	5.9	10.8	63.7	77.5	386	6.1

ECO 2303C (1470KV)

7.4V Motor @ Optimum Efficiency 最佳效率点

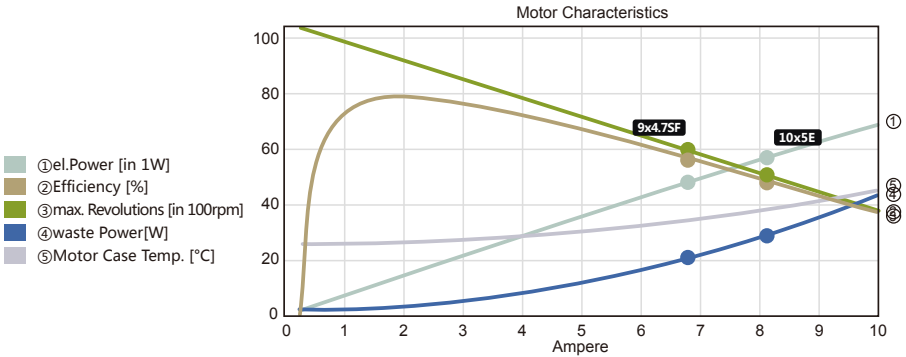
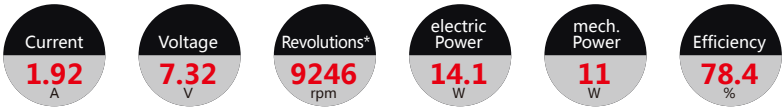

Voltage (V)	Propeller (RPM)	Throttle (%)	Current (A)	Voltage (V)	el. Power (W)	Efficiency (%)	Thrust (g)	Spec. Thrust (g/W)
7.4V (2S LIPO)	9x4.75F							
	3200	43	0.9	7.4	6.7	65.1	94	14.1
	3600	50	1.3	7.4	9.7	64.3	119	12.3
	4000	58	1.9	7.3	13.5	63.2	148	10.9
	4400	66	2.5	7.3	18.4	61.9	178	9.7
	4800	74	3.4	7.3	24.4	60.6	212	8.7
	5200	83	4.4	7.3	31.7	59.3	249	7.9
	5600	92	5.7	7.2	40.5	57.9	289	7.1
	5899	100	6.8	7.2	48.6	56.6	321	6.6
	10x5E							
	3000	46	1.4	7.4	10	58.6	121	12.1
	3300	53	1.9	7.3	13.6	57.2	147	10.8
	3600	60	2.5	7.3	18.1	55.9	174	9.6
	3900	67	3.3	7.3	23.6	54.5	205	8.7
	4200	75	4.2	7.3	30.2	53.1	237	7.9
	4500	83	5.3	7.2	38.1	51.7	272	7.1
	4800	92	6.7	7.2	47.4	50.5	310	6.5
	5050	100	8.1	7.2	57.1	49.1	343	6

11.1V Motor @ Optimum Efficiency 最佳效率点

Current
2.37
A

Voltage
10.94
V

Revolutions*
13910
rpm

electric Power
29.9
W

mech. Power
23.8
W

Efficiency
79.5
%

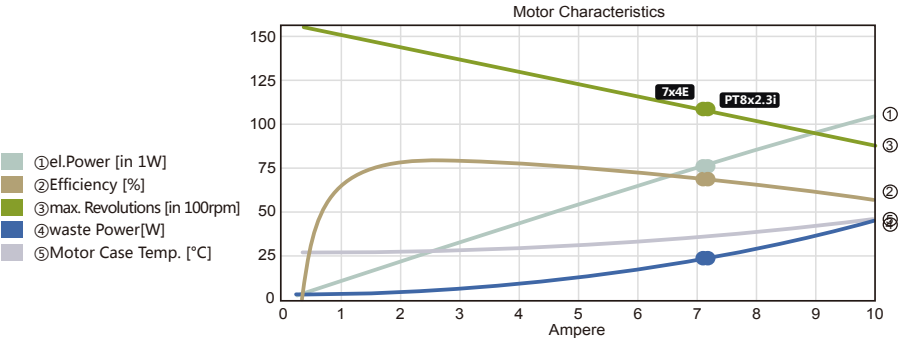

Voltage (V)	Propeller (RPM)	Throttle (%)	Current (A)	Voltage (V)	el. Power (W)	Efficiency (%)	Thrust (g)	Spec. Thrust (g/W)
11.1V (3S LIPO)	7x4E							
	5600	44	0.9	11.1	9.6	74.5	99	10.3
	6400	51	1.3	11	14.4	74.4	130	9
	7200	59	1.9	11	20.6	73.9	164	8
	8000	67	2.6	11	28.6	73.1	203	7.1
	8800	76	3.5	10.9	38.5	72.1	245	6.4
	9600	85	4.7	10.9	50.7	71.1	292	5.8
	10400	94	6.1	10.8	65.5	70	343	5.2
	10832	100	7.1	10.8	76.1	68.7	372	4.9
	PT8x2.3i							
	5600	44	0.9	11.1	9.8	74.4	116	11.8
	6400	51	1.3	11	14.7	74.2	151	10.3
	7200	59	1.9	11	21.1	73.7	191	9.1
	8000	67	2.7	11	29.2	72.9	236	8.1
	8800	76	3.6	10.9	39.4	71.9	286	7.3
	9600	85	4.8	10.9	51.9	70.8	340	6.5
	10400	95	6.3	10.8	67.1	69.7	399	6
	10783	100	7.2	10.8	76.8	68.4	429	5.6

ECO 2304C-V2



Dimensions

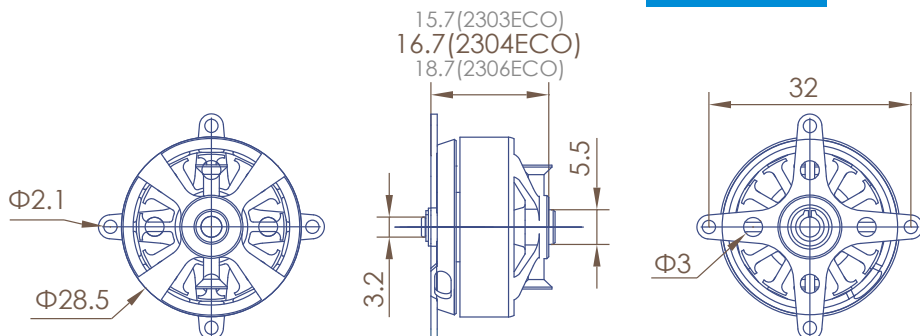

Specification

ECO-C Series	ECO 2304C		
SKU(商品编码)	51638	51639	51640
KV(KV值)	2300	1850	1450
Turns(匝数)	14.5	18	23
Weight(g)(重量)	23	23	23
Dimensions(D x L)[mm](尺寸)	28.5x16.7	28.5x16.7	28.5x16.7
Slots & Poles(槽数, 极数)	12N14P	12N14P	12N14P
Ri(mOhm)(电阻)	103.0	165.0	230.0
Io @10V (A)(空载电流)	0.6	0.7	0.3
No.of Cells(LiPo)(适用电池)	2..3	2..3	2..3
Max. EfficiencyCurrent[A](效率电流)	9	7.6	6
Max. Burst Current (15S)[A](最大电流)	15	12	10
Max. Power(15S)[W](最大功率)	120	96	120
Max. Torque [N*M](最大扭矩)	0.075	0.074	0.079
Shaft diameter(mm)(轴径)	3.175	3.175	3.175
Mountingholes pitch(安装孔距)	32	32	32
Input Connectors(输入链接)	GC2.0	GC2.0	GC2.0
RecommendedESC(调速器)	XC-12-LITE or XC1210BA	XC-12-LITE or XC1210BA	XC-12-LITE or XC1210BA
Propeller(螺旋桨)	2S: 8x3E, PT 9x2.8i 3S: 5.1x4.5E	2S: 9x4.7SF, PT10x2.8i 3S: 5.1x4.5E, 6x3E	2S: 8x4.7E, 9x4.7E 3S: 7x4E, 8x4E
Class(适用机种)	100-200g airplane.g. Indoor freestyle or EPP F3P trainer		

ECO 2304C (2300KV)

7.4V Motor @ Optimum Efficiency 最佳效率点

Current
5.02
A

Voltage
7.18
V

Revolutions*
14703
rpm

electric
Power
36
W

mech.
Power
30.3
W

Efficiency
84
%

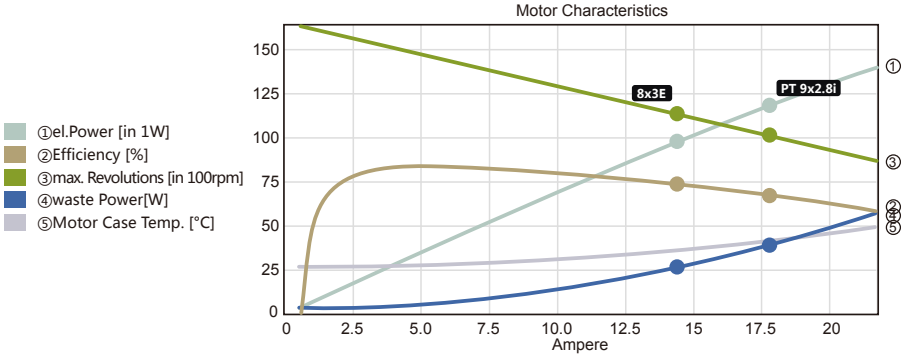

Voltage (V)	Propeller (RPM)	Throttle (%)	Current (A)	Voltage (V)	el. Power (W)	Efficiency (%)	Thrust (g)	Spec. Thrust (g/W)
7.4V (2S LIPO)	8x3E							
	4800	35	1.1	7.4	7.6	77	95	12.5
	5600	41	1.7	7.3	12	77.5	130	10.8
	6400	48	2.5	7.3	18	77.4	169	9.4
	7200	56	3.6	7.3	25.8	76.9	214	8.3
	8000	64	5	7.2	35.8	76.1	265	7.4
	8800	72	6.9	7.2	48.2	75.2	320	6.6
	9600	81	9.1	7.1	63.5	74.1	381	6
	10400	91	11.9	7	81.9	73.1	447	5.5
	11095	100	15	6.9	101.6	71.8	509	5
	PT 9x2.8i							
	4900	38	1.7	7.3	12.5	74.8	132	10.5
	5600	45	2.6	7.3	18.8	74.2	172	9.1
	6300	52	3.8	7.3	27.2	73.2	218	8
	7000	60	5.4	7.2	37.9	72	269	7.1
	7700	68	7.3	7.2	51.3	70.8	326	6.3
	8400	77	9.8	7.1	67.8	69.5	388	5.7
	9100	86	12.9	7	87.9	68.2	455	5.2
	9800	97	16.8	6.9	111.9	66.9	527	4.7
	9986	100	18.1	6.8	120	66.3	548	4.6

11.1V Motor @ Optimum Efficiency 最佳效率点

Current
7.3
A

Voltage
10.69
V

Revolutions*
21925
rpm

electric
Power
78.1
W

mech.
Power
65.9
W

Efficiency
84.4
%

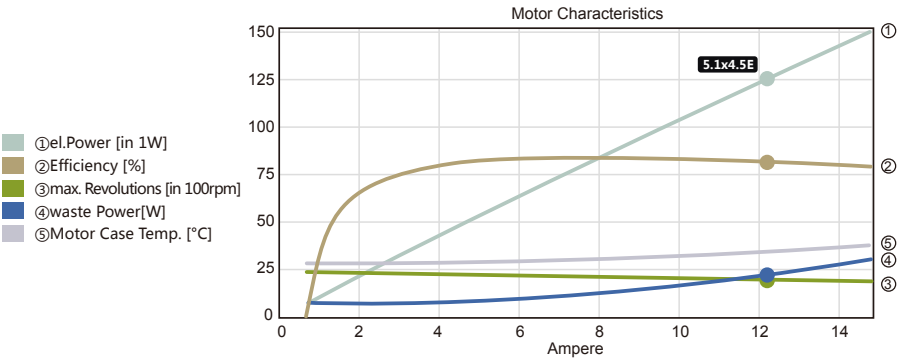

Voltage (V)	Propeller (RPM)	Throttle (%)	Current (A)	Voltage (V)	el. Power (W)	Efficiency (%)	Thrust (g)	Spec. Thrust (g/W)
11.1V (3S LIPO)	5.1x4.5E							
	3000	13	0.1	11.1	0.8	44.2	14	18
	4500	19	0.2	11.1	1.9	62.5	33	16.9
	6000	26	0.4	11.1	3.9	72.6	58	14.7
	7500	33	0.6	11.1	7.1	78.1	90	12.7
	9000	40	1.1	11.1	11.8	81.1	130	11
	10500	47	1.7	11	18.4	82.8	177	9.6
	12000	54	2.5	11	27.2	83.6	231	8.5
	13500	62	3.6	10.9	38.6	83.9	293	7.6
	15000	70	4.9	10.9	53	83.9	361	6.8
	16500	79	6.6	10.8	70.7	83.7	437	6.2
	18000	87	8.7	10.7	92.2	83.4	520	5.6
	19500	97	11.3	10.6	117.8	82.9	611	5.2
	19972	100	12.3	10.5	128.3	82.2	641	5

ECO 2304C (1850KV)

7.4V Motor @ Optimum Efficiency 最佳效率点

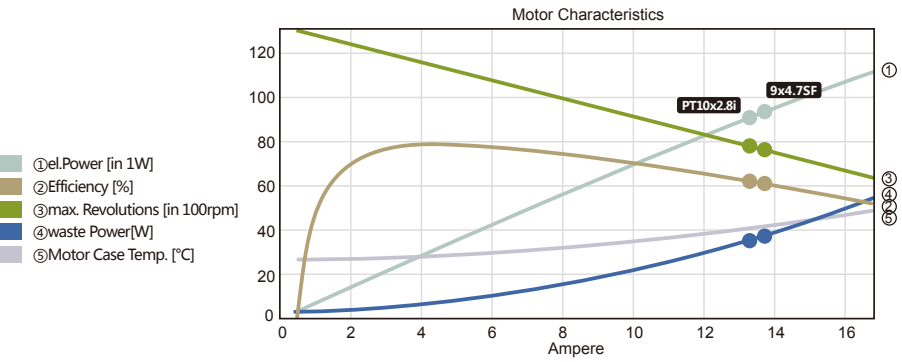
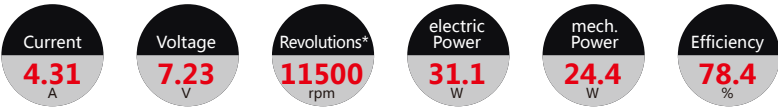

Voltage (V)	Propeller (RPM)	Throttle (%)	Current (A)	Voltage (V)	el. Power (W)	Efficiency (%)	Thrust (g)	Spec. Thrust (g/W)
7.4V (2S LIPO)	9x4.75F							
	3000	30	0.7	7.4	5.4	66.2	83	15.2
	3500	35	1.2	7.4	8.5	67	113	13.2
	4000	42	1.8	7.3	12.7	67	148	11.6
	4500	48	2.5	7.3	18.3	66.5	187	10.2
	5000	56	3.5	7.3	25.4	65.6	230	9.1
	5500	63	4.8	7.3	34.4	64.6	279	8.1
	6000	71	6.4	7.2	45.5	63.4	332	7.3
	6500	80	8.4	7.1	59	62.2	390	6.6
	7000	89	10.8	7.1	75.1	60.9	452	6
	PT10x2.8i							
	7502	100	14	7	95.6	59.3	519	5.4
	5000	54	3.1	7.3	22.6	67	188	8.3
	5500	61	4.3	7.3	30.5	66.1	228	7.5
	6000	69	5.7	7.2	40.2	65.1	271	6.7
	6500	77	7.4	7.2	52	64	318	6.1
	7000	86	9.5	7.1	66.2	62.8	369	5.6
	7500	95	12	7	82.9	61.7	424	5.1
	7719	100	13.5	7	92.3	60.8	449	4.9

11.1V Motor @ Optimum Efficiency 最佳效率点

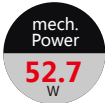

- ① el.Power [in 1W]
- ② Efficiency [%]
- ③ max. Revolutions [in 100rpm]
- ④ waste Power[W]
- ⑤ Motor Case Temp. [°C]

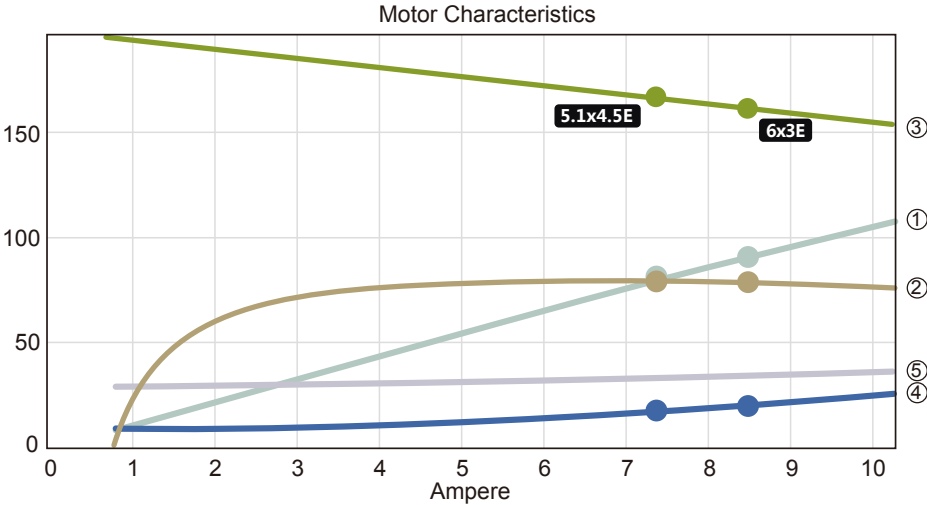

Voltage (V)	Propeller (RPM)	Throttle (%)	Current (A)	Volage (V)	el. Power (W)	Efficiency (%)	Thrust (g)	Spec. Thrust (g/W)
11.1V (3S LIPO)	5.1x4.5E							
	3600	19	0.1	11.1	1.5	41.9	21	14.2
	4800	26	0.2	11.1	2.7	54.8	37	13.9
	6000	32	0.4	11.1	4.5	63.7	58	12.9
	7200	39	0.6	11.1	7.1	69.5	83	11.8
	8400	46	1	11.1	10.6	73.5	113	10.7
	9600	53	1.4	11	15.3	76	148	9.7
	10800	60	1.9	11	21.4	77.8	187	8.8
	12000	68	2.6	11	28.9	78.9	231	8
	13200	76	3.5	10.9	38.1	79.6	280	7.3
	14400	84	4.5	10.9	49.2	79.9	333	6.8
	15600	92	5.8	10.8	62.4	80.1	391	6.3
	16709	100	7.3	10.8	77.9	79.2	448	5.8
	6x3E							
	4800	26	0.3	11.1	3.1	59.7	40	12.9
	6000	33	0.5	11.1	5.4	67.6	63	11.7
	7200	40	0.8	11.1	8.7	72.5	90	10.4
	8400	47	1.2	11	13.2	75.6	123	9.3
	9600	54	1.8	11	19.2	77.5	161	8.4
	10800	62	2.5	11	27	78.7	203	7.5
	12000	70	3.4	10.9	36.7	79.3	251	6.8
	13200	78	4.5	10.9	48.7	79.6	304	6.2
	14400	87	5.9	10.8	63.2	79.6	362	5.7
	15600	95	7.5	10.8	80.4	79.4	424	5.3
	16148	100	8.6	10.7	90.9	78.4	455	5

ECO 2304C (1450KV)

7.4V Motor @ Optimum Efficiency 最佳效率点

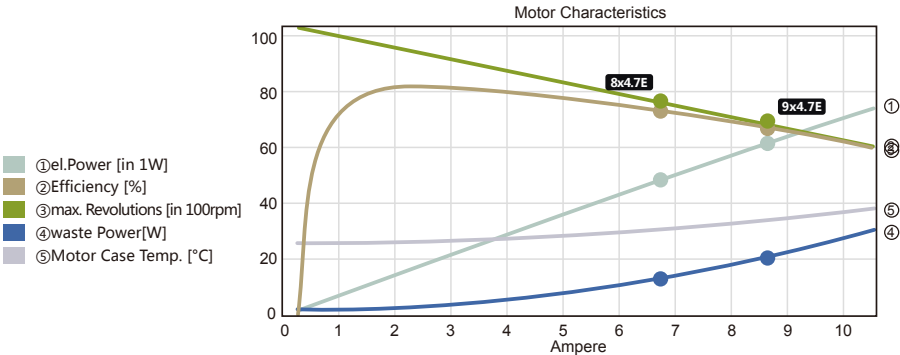
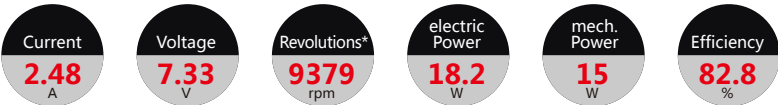

Voltage (V)	Propeller (RPM)	Throttle (%)	Current (A)	Voltage (V)	el. Power (W)	Efficiency (%)	Thrust (g)	Spec. Thrust (g/W)
7.4V (2S LIPO)	8x4.7E							
	4500	53	1.3	7.4	9.9	76.8	131	13.3
	5000	60	1.9	7.4	13.6	76.5	162	11.9
	5500	67	2.5	7.3	18.2	76	196	10.7
	6000	75	3.3	7.3	23.9	75.3	233	9.8
	6500	82	4.2	7.3	30.7	74.5	274	8.9
	7000	91	5.4	7.3	38.8	73.7	317	8.2
	7500	99	6.7	7.3	48.3	72.8	364	7.5
	7547	100	6.9	7.3	49.6	72.4	369	7.4
	9x4.7E							
	3500	43	1.1	7.4	7.8	73.6	113	14.5
	4000	50	1.6	7.4	11.7	72.9	148	12.6
	4500	58	2.3	7.4	16.9	71.9	187	11
	5000	67	3.2	7.3	23.6	70.7	230	9.8
	5500	75	4.4	7.3	32	69.4	279	8.7
	6000	85	5.9	7.3	42.3	68.1	332	7.8
	6500	95	7.7	7.2	54.9	66.8	390	7.1
	6759	100	8.8	7.2	62.8	65.8	421	6.7

11.1V Motor @ Optimum Efficiency 最佳效率点

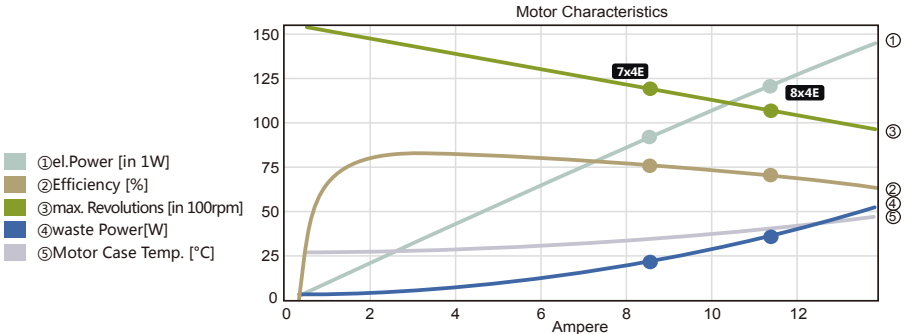
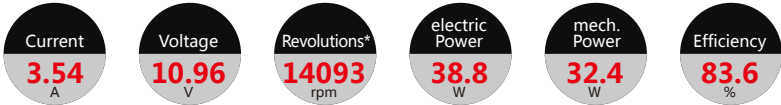

Voltage (V)	Propeller (RPM)	Throttle (%)	Current (A)	Voltage (V)	el. Power (W)	Efficiency (%)	Thrust (g)	Spec. Thrust (g/W)
11.1V (3S LIPO)	7x4E							
	6300	47	1.2	11.1	12.9	80.6	147	11.4
	7200	54	1.8	11	19.2	80.6	191	9.9
	8100	62	2.5	11	27.5	80.3	242	8.8
	9000	71	3.5	11	38	79.7	299	7.9
	9900	79	4.7	11	51.1	78.9	362	7.1
	10800	88	6.2	10.9	67.1	78.1	431	6.4
	11700	97	8	10.9	86.3	77.2	505	5.9
	11918	100	8.6	10.8	92.6	76.4	524	5.7
	8x4E							
	5600	44	1.5	11.1	16.1	77.5	173	10.7
	6400	52	2.2	11	24.3	76.7	226	9.3
	7200	60	3.2	11	35	75.6	286	8.2
	8000	68	4.5	11	48.8	74.4	353	7.2
	8800	77	6.1	10.9	66.1	73.1	427	6.5
	9600	87	8.1	10.8	87.4	71.8	508	5.8
	10400	97	10.6	10.8	113.1	70.5	596	5.3
	10638	100	11.6	10.7	123.2	69.7	624	5.1